

### Sensor Model IL dimensions, mm

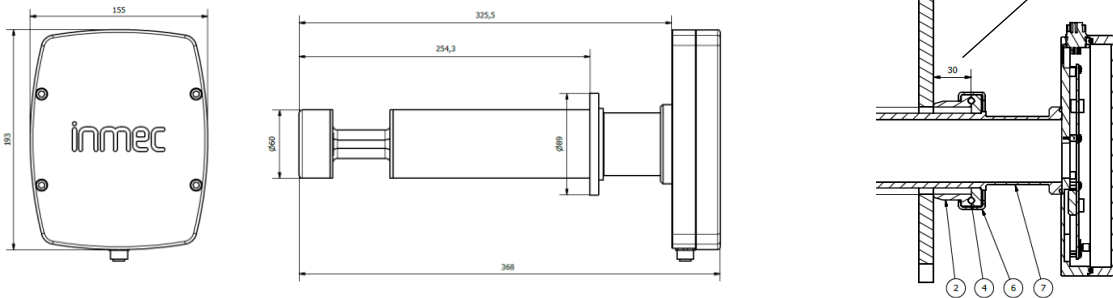

### Display Unit, connections

Power and I/O CONNECTIONS			
X1			
11	+	24 VDC Main Power	To fuse
12	-	24 VDC Main Power	Blue
13	+	24 VDC to sensor	Red
14	+	Brix, 4-20 mA output Active	Pink
15	-	Brix, 4-20 mA output Active	Grey
16	+	Temp, 4-20 mA output Active	Green
17	-	Temp, 4-20 mA output Active	Yellow
18		4-20 mA via display to X1;16	Grey

### Display unit



Tablet and Remote CONNECTIONS			
X2			
21	-	Rs-485 Remote (Gateway)	
22	-	RS-485 Local (Tablet)	Brown
23	+	Rs-485 Remote (Gateway)	
24	+	RS-485 Local (Tablet)	White

Tablet cable



### Tablet

- Windows 10
- Touch screen
- In-built Cellular
- All sensor tuning functions
- Manages all sensors of a mill

### Display unit Features

- Numeric display of Brix
- 4-20 mA Outputs, Active
- Sensor power. 24VDC,3A
- Tablet connector
- Gateway connection

### Dimensions

230\*130\*100 mm

### Sensor specifications Inmec Model IL/SRC, In-Line sensor

#### Measurement

Operating power	Sensor	24V, 3 Amps
Microwave power		15 mW
Connection	Cable to Connection unit, 8 wire shielded. Connectors Aisi316L	
Process connection	Union-L coupling welded ,76.1 mm , Aisi 316L. Optional Bolt adapters	
Gasket	O-ring EPDM, Viton as option	
Measuring range	Factory configured by customer specification	
Repeatability	+/- 0.01 % concentration	
Sensitivity	+/-0.001% concentration	
Measuring resolution	0.01% concentration	
Output filtering	1 – 300s	
Output 1	Brix output. 4 – 20 mA, Active and Isolated. Max load 750 Ohm	
Output 2	Temperature output. 4 – 20 mA, Active and Isolated. Max load 750 Ohm	
Signal processor	DSP	

#### Process conditions

pH range	3 – 11
Temperature	0 – 140 C
Pressure	
Minimum	Recommended min 1.5 bar to avoid free air
Maximum	PN10,
Conductivity	Max. 13mS/cm

#### Environment

Temperature	0 – +70 ; Protection needed in case of direct heat source
Housing	IP65
Vibration	max. 20 m/s <sup>2</sup> 10-2000Hz

#### Materials

Model IL	Sensor body, Aisi 316L. Installation weld ring Aisi 316L
Housing Parts	Aluminum, Anonized
Antennas	Ceramic
<b>Sensor weight</b>	3.4 kg

### Display Unit specifications

Operating power	24VDC, 3 A
Connection	Cable to sensor, 10m, 8 wire shielded. Connectors Aisi316L

#### Environment

Temperature	0 – +70
Housing	IP65

<b>Material</b>	ABS Plastic
-----------------	-------------

<b>Unit weight</b>	1 kg
--------------------	------

<b>Dimensions</b>	230*130*100 mm
-------------------	----------------

<b>Wall mount</b>	4 bolts, Corner loops
-------------------	-----------------------

#### Features:

- Numeric display of Brix, Density or %-Concentration
- I/O connections
- 24VDC, 3A power supply for the sensor
  - 4 -20mA outputs forwarded from the sensor, Active and Isolated, Max. load 750 Ohm
  - RS 485 serial link to external Gateway unit
  - Connection to the Operating Tablet, USB